

TCORX
FITNESS IN MOTION

INSTRUCTION



WBX70



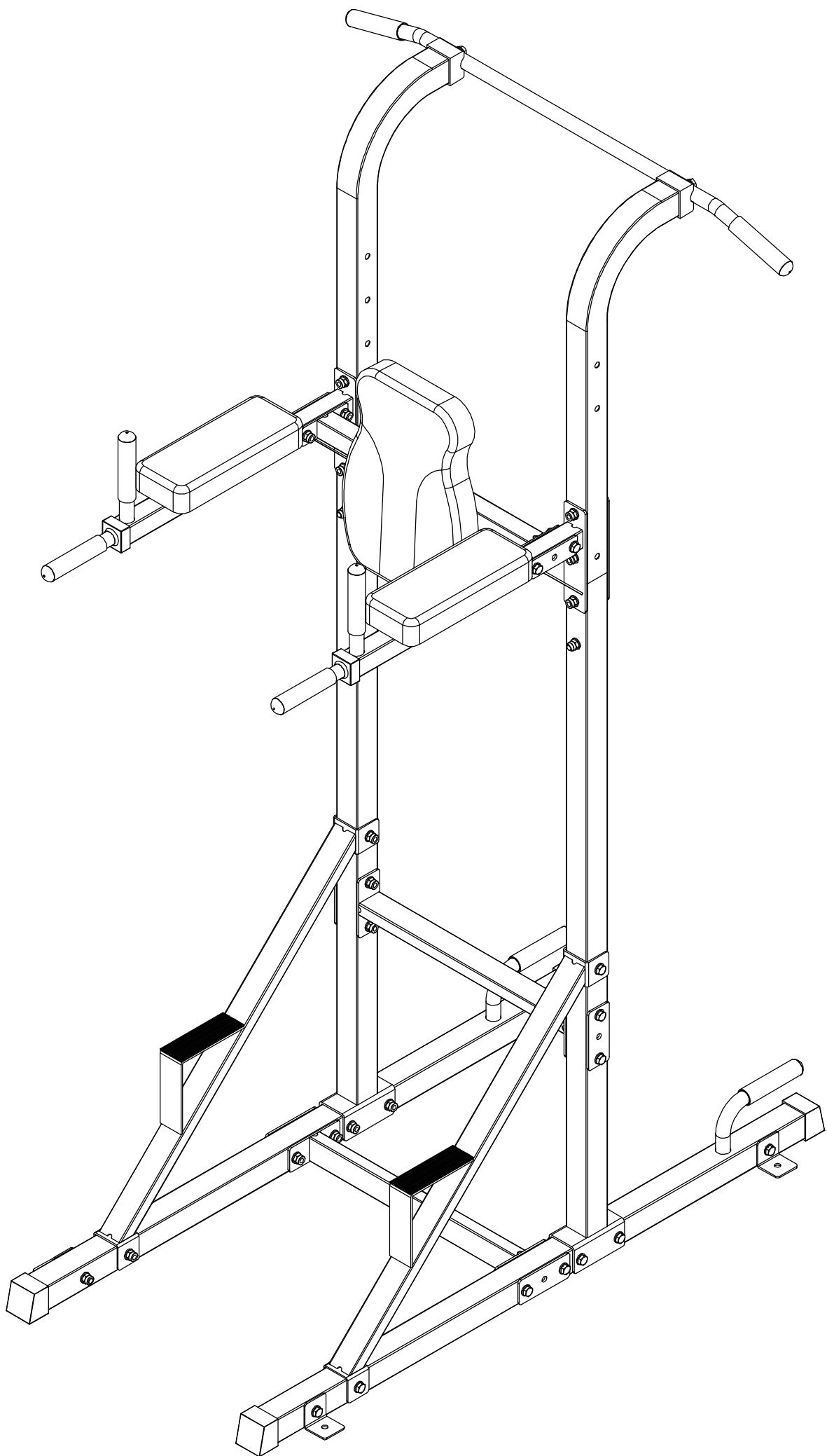

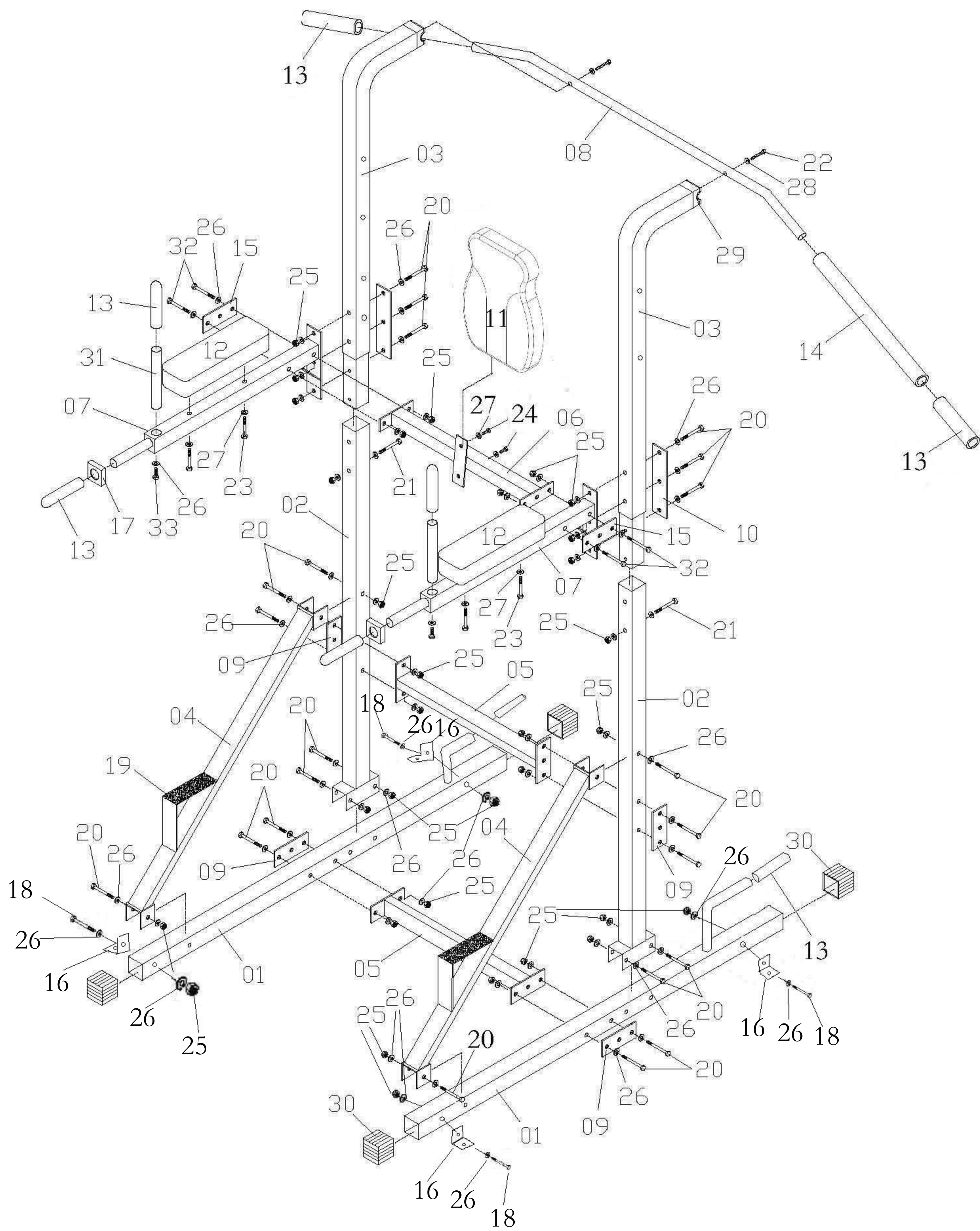

PART LIST

PART	DESCRIPTIION	Q'TY
1.	MAIN BASE	2
2.	BOTTOM UPRIGHT FRAME	2
3.	UPPER UPRIGHT FRAME	2
4.	SUPPORT BAR	2
5.	CENTER CROSS SUPPORT	2
6.	BACKREST SUPPORT TUBE	1
7.	DIP HANDLE ARM	2
8.	LAT BAR	1
9.	STEEL PLATE(50MM)	4
10.	STEEL PLATE (LONG)	2
11.	BACKREST	1
12.	ARM REST	2
13.	HAND GRIP	8
14.	LAT BAR FOAM PAD (LONG)	1
15.	STEEL PLATE(38MM)	2
16.	L shaped fixture plate	4
17.	SQUARE CAP \varnothing 26x \square 38 MM	2
18.	M10*70 BOLT	4
19.	SKIDPROOF	2
20.	M10*75 BOLT	22
21.	M10*65 BOLT	2
22.	M10*55 BOLT	2
23.	M8*55 BOLT	4
24.	M8*16 BOLT	2
25.	M10 NYLON NUT	32
26.	M10 WASHER	66
27.	M8 WASHER	6
28.	M10 ARC WASHER	2
29.	BUSHING	2
30.	RUBBER END CAP	4
31.	HANDLE PIPE	2
32.	M10*60 BOLT	4
33.	M10*25 BOLT	2

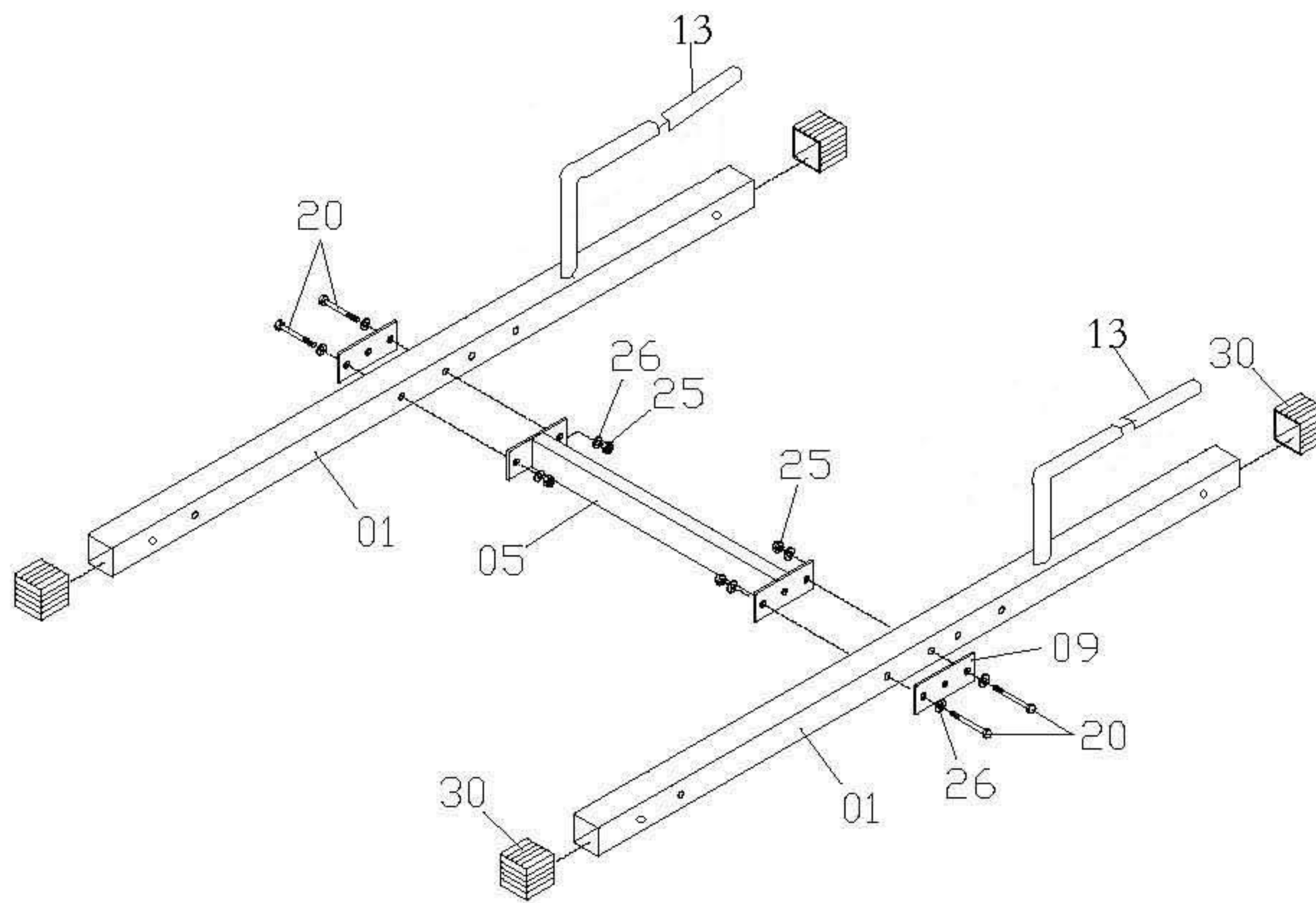

STEP 01

1. PLACE RUBBER END CAP (30) ONTO BOTH ENDS OF MAIN BASE (01).
2. CONNECT CENTER CROSS SUPPORT (05) TO CATCH MAIN BASE (01) BY USING BOLTS (20) STEEL PLATE (09) AND NUTS (25) WASHERS (26).
3. SLIDE HAND GRIP (13) ONTO MAIN BASE (01) AS SHOWN.

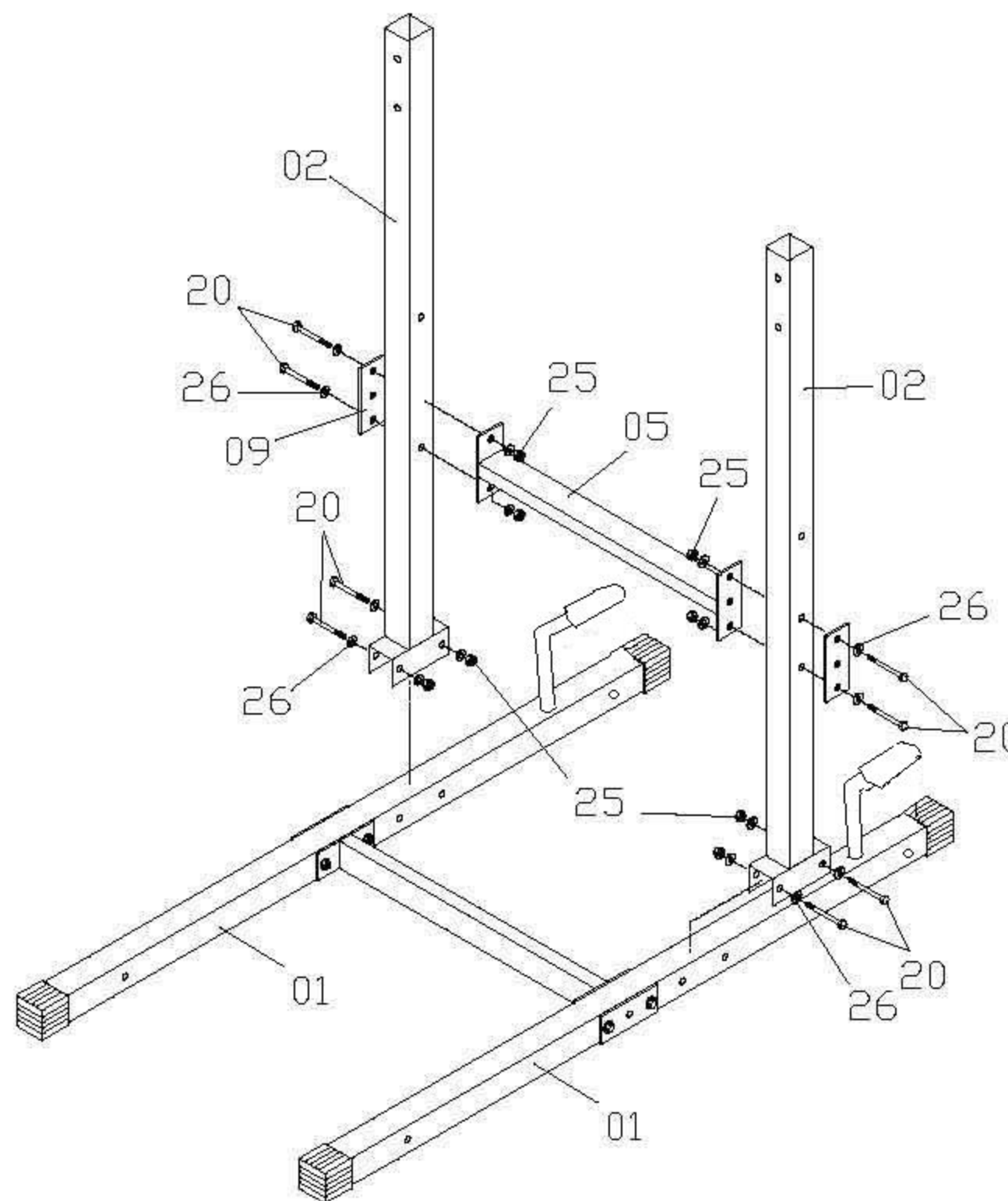

STEP 02

1. CONNECT BOTTOM UPRIGHT FRAME (02) ONTO MAIN BASE (01) BY USING BOLTS (20) WASHERS (26) NUTS (25) AS SHOWN.
2. CONNECT CENTER CROSS SUPPORT (05) TO CATCH BOTTOM UPRIGHT FRAME (02) BY USING BOLTS (20) STEEL PLATE (09) AND WASHERS (26) NUTS (25) AS SHOWN.

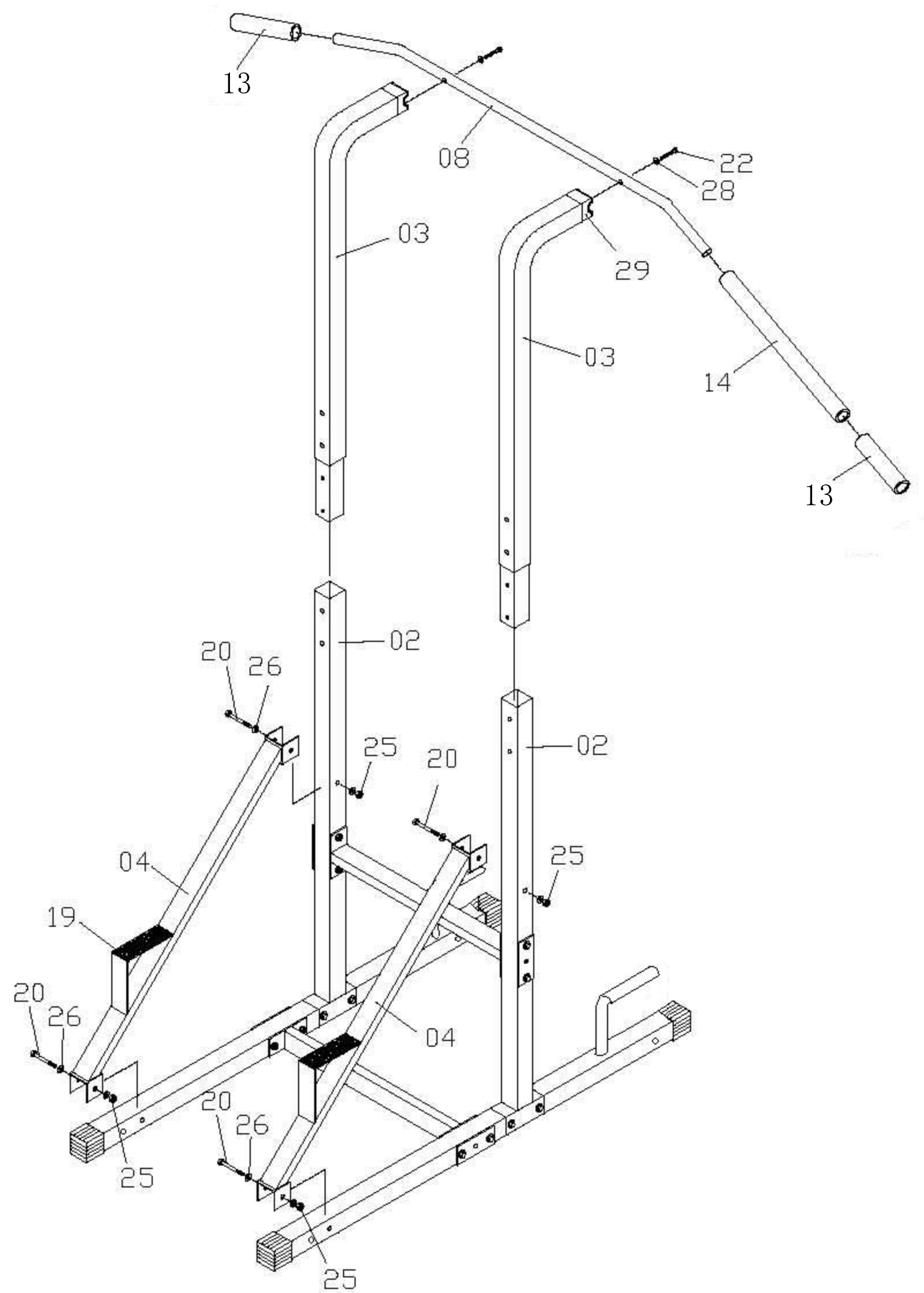

STEP 03

1. CONNECT UPPER UPRIGHT FRAME (03) INTO BOTTOM UPRIGHT FRAME (02)
2. SLIDE FOAM PAD (14,13) ONTO LAT BAR (08) AS SHOWN.
3. CONNECT LAT BAR (08) INTO THE UPPER UPRIGHT FRAME (03) BY USING BOLTS (22) AND ARC WASHERS (28) AS SHOWN.

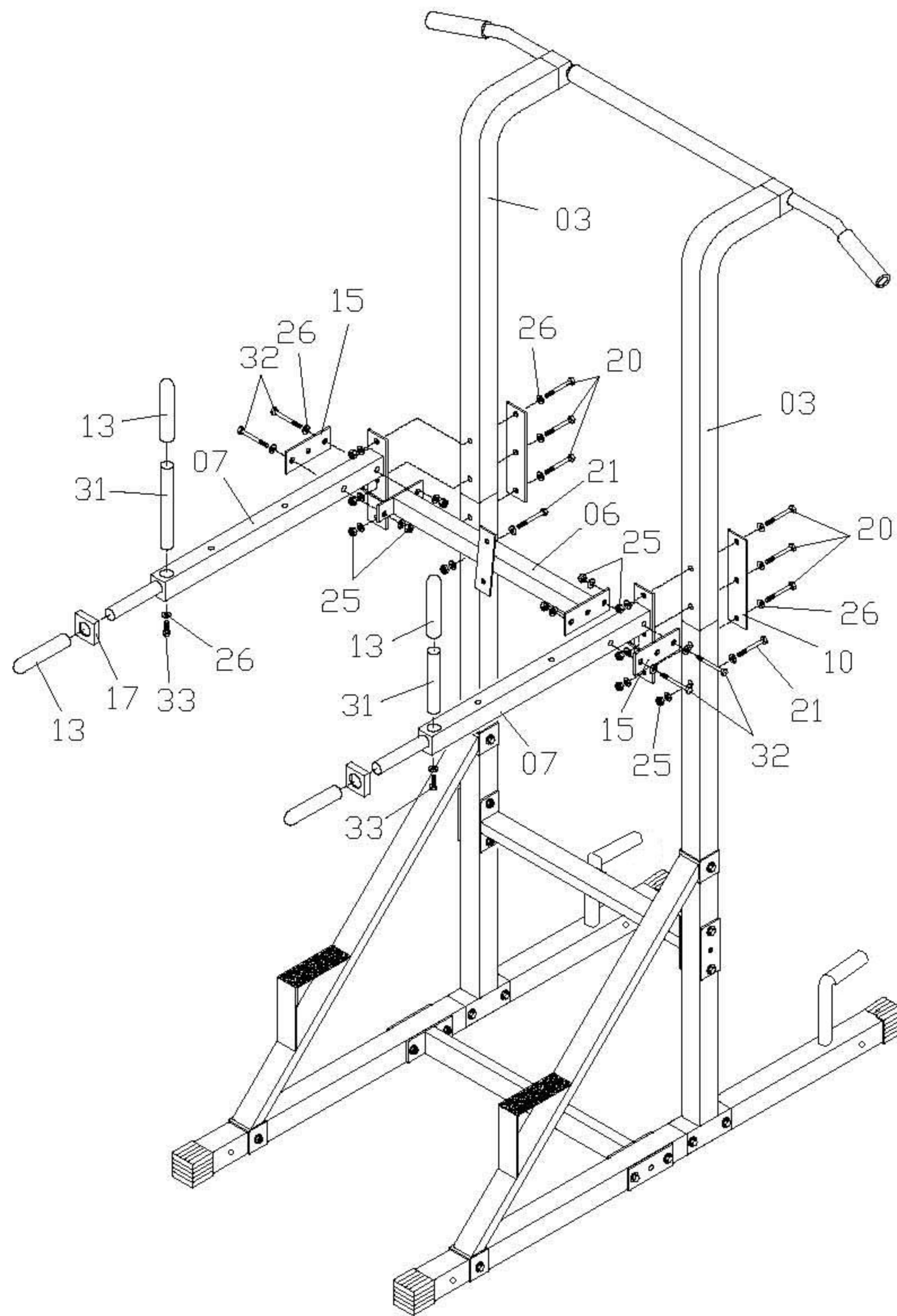

STEP 04

1. CONNECT DIP HANDLE ARM (07) TO THE UPPER UPRIGHT FRAME (03) BY USING BOLTS (20) STEEL PLATE (10) AND WASHERS (26) NUTS (25).
2. CONNECT BACKREST SUPPORT TUBE (06) ONTO DIP HANDLE ARM (07) BY USING BOLTS (32) STEEL PLATE (15) AND WASHERS (26) NUTS (25).
3. INSERT HANDLE PIPE (31) INTO DIP HANDLE ARM (07) USING BOLTS (33) AND WASHERS (26) AS SHOWN.
4. SLIDE HAND GRIP (13) ONTO DIP HANDLE ARM (07) AND HANDLE PIPE (31).

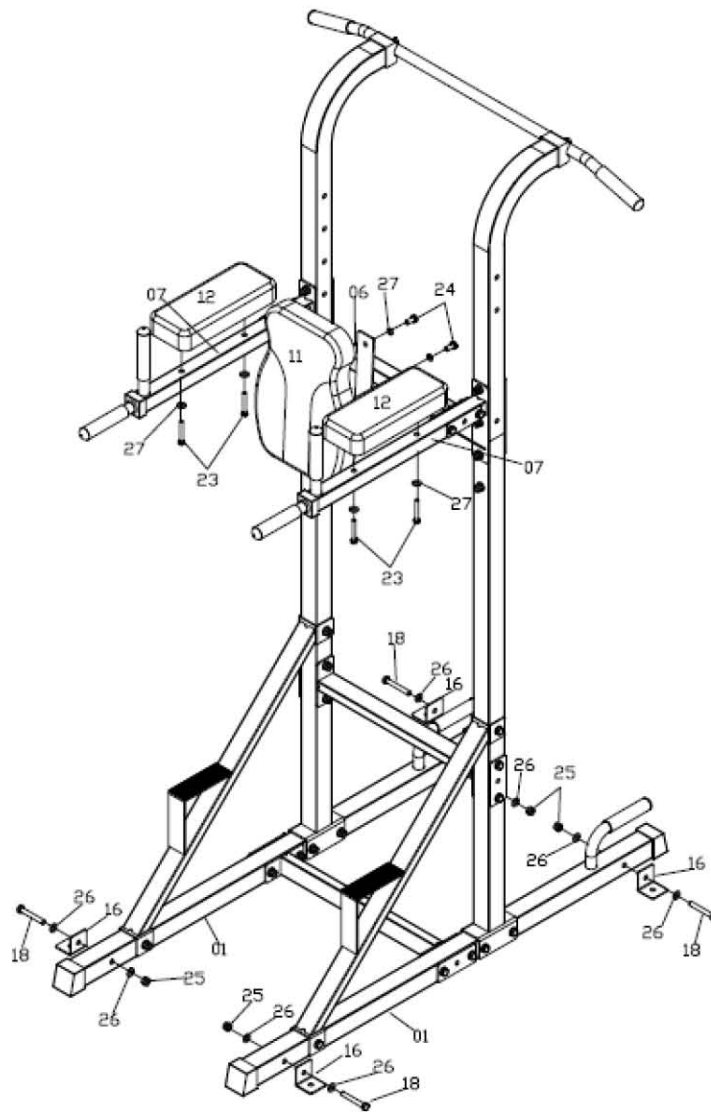

STEP 05

1. ATTACH BACKREST (11) ONTO BACKREST SUPPORT TUBE (06) BY USING BOLTS (24) WASHERS (27).
2. ATTACH ARM REST (12) ONTO DIP HANDLE ARM (07) BY USING BOLTS (23) WASHERS (27) AS SHOWN.
3. Fix L shaped fixture plate (16) to the bottom tube (01) by the bolts (18), washers (26) and nuts (25).

TCORX
FITNESS IN MOTION

INSTRUCTION



KIT-PALLAWBX-70

boxing speed ball kit

OPTIONAL



Instruction manual for Speed ball equipment

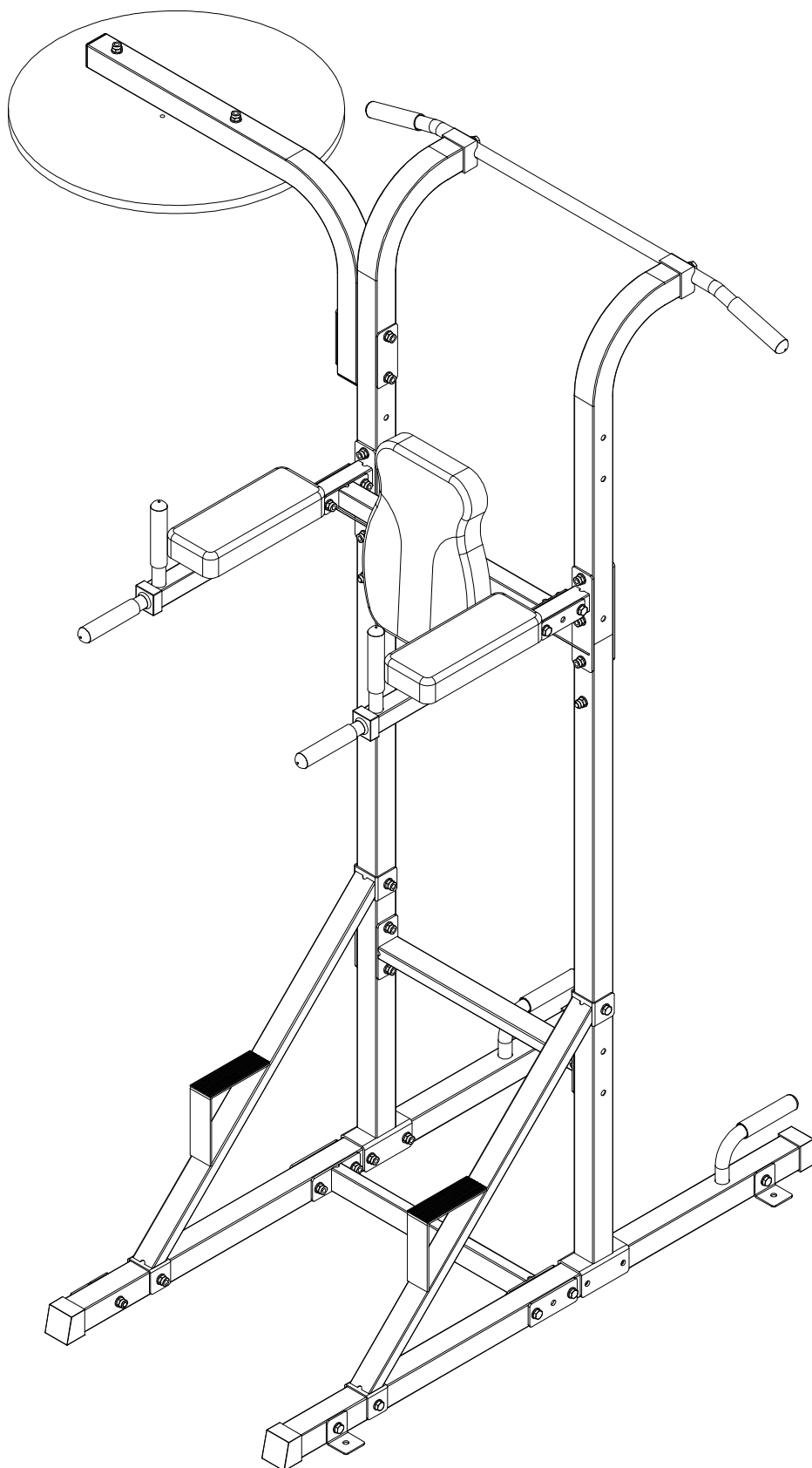

Part list

No.	Description	Q'ty
1	Speed ball fixation tube	1
2	Round wooden board	1
3	Speed ball rotator	1
4	Square inner cap	2
5	M10X120 hex bolt	2
6	M10X75 bolt	2
7	M5X16 bolt	4
8	M10 washer	6
9	M10 nut	4
10	Connecting plate	2

Part drawing:

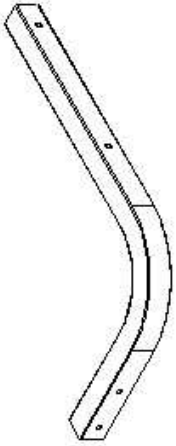

Speed ball fixture tube

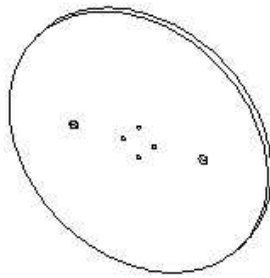

Wooden board

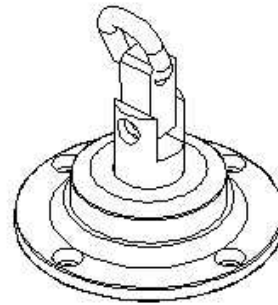

Speed ball rotator

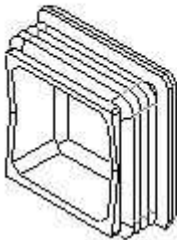

Square inner cap



Connecting plate

Hardware components:

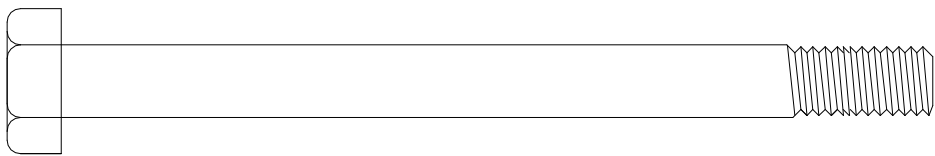

NO. 5 Hex Bolt M10x120mm

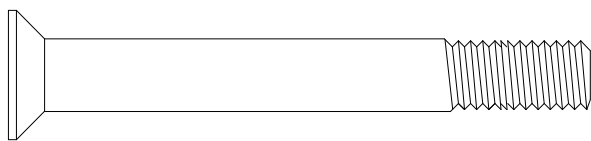

NO. 6 十字沉头螺丝 M10x75mm



NO. 7 十字沉头螺丝 M5x16mm

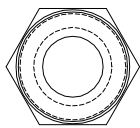

NO. 9 Nylon Nut M10

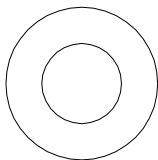

NO. 8 Washer M10

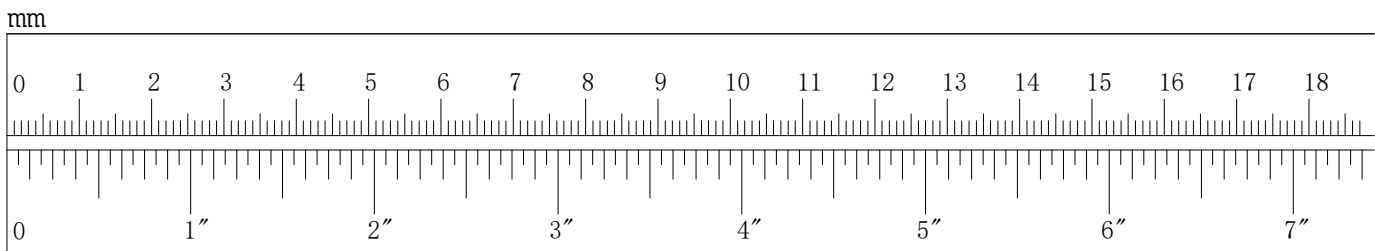

Exploding drawing:

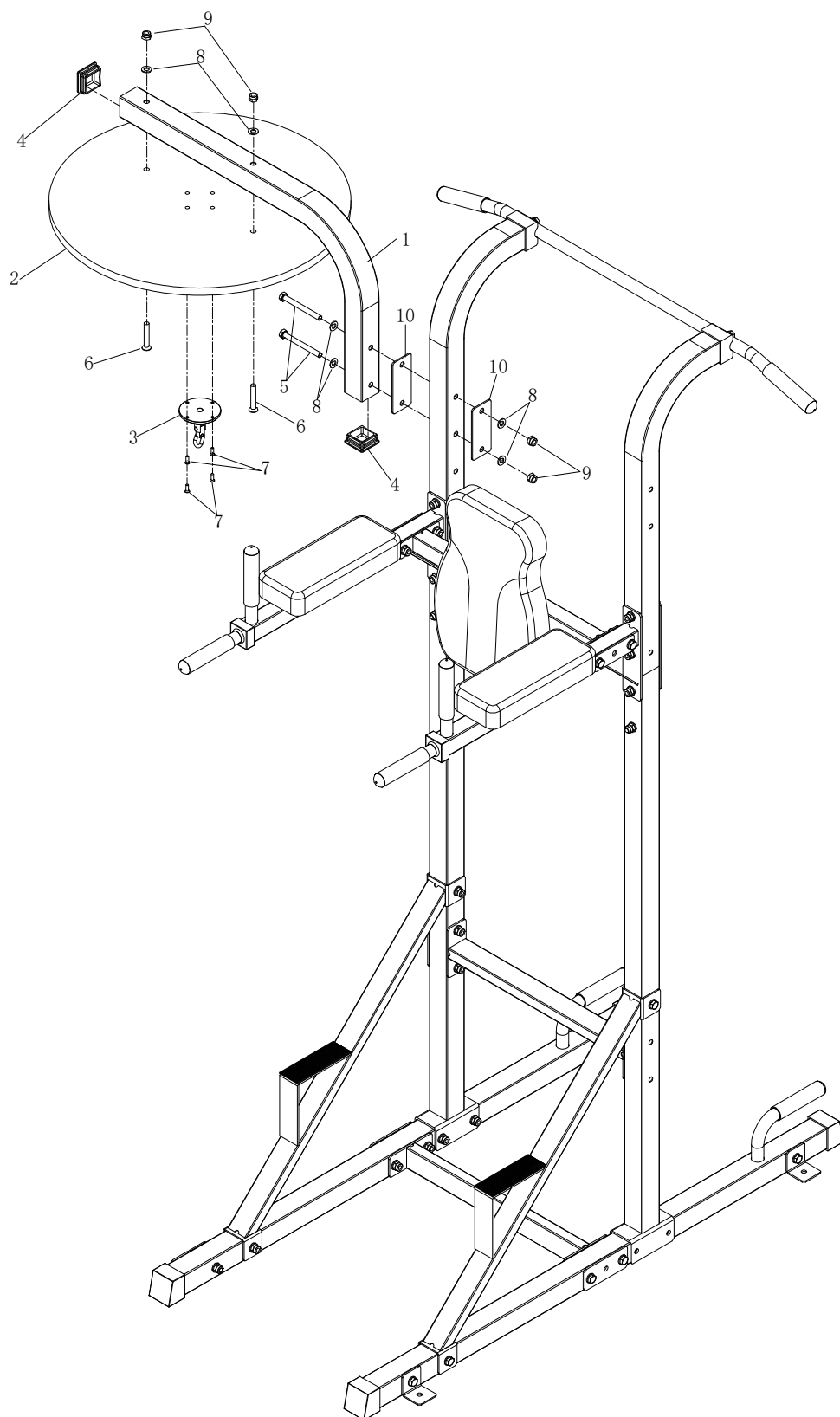

Assembly instruction:

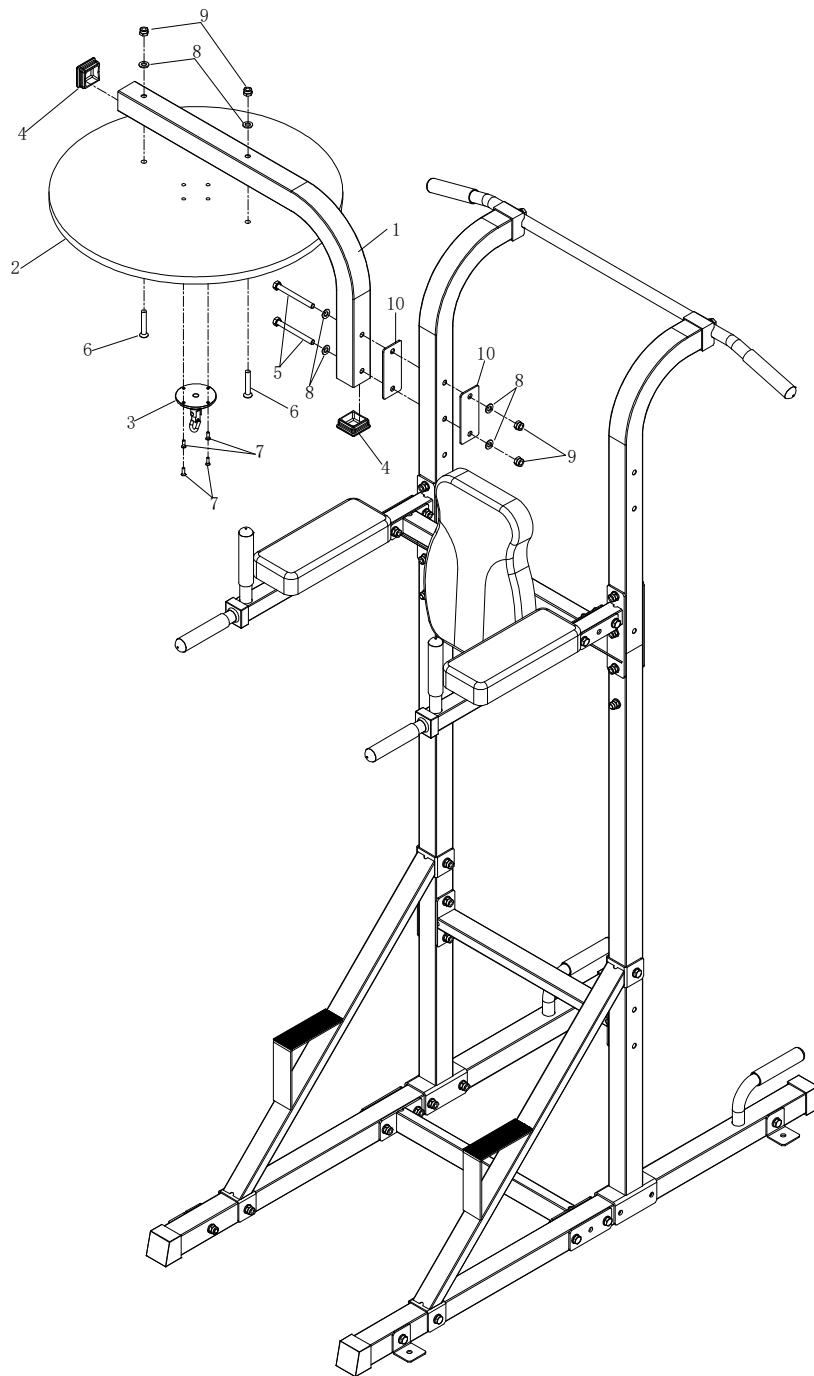

- a) Assemble the speed ball rotator (3) to the round wooden board (2) by the bolt (7).
- b) Then fix the round wooden board (2) to the speed ball fixture tube (1) by bolt (6); Finally, connect the speed ball fixture tube (1) with connecting plate (10) by hex bolt (5) and washer (8) and nut (9) to the left upright post.

TCORX
FITNESS IN MOTION

INSTRUCTION



KIT-SACCOWBX-70

boxing bag kit

OPTIONAL



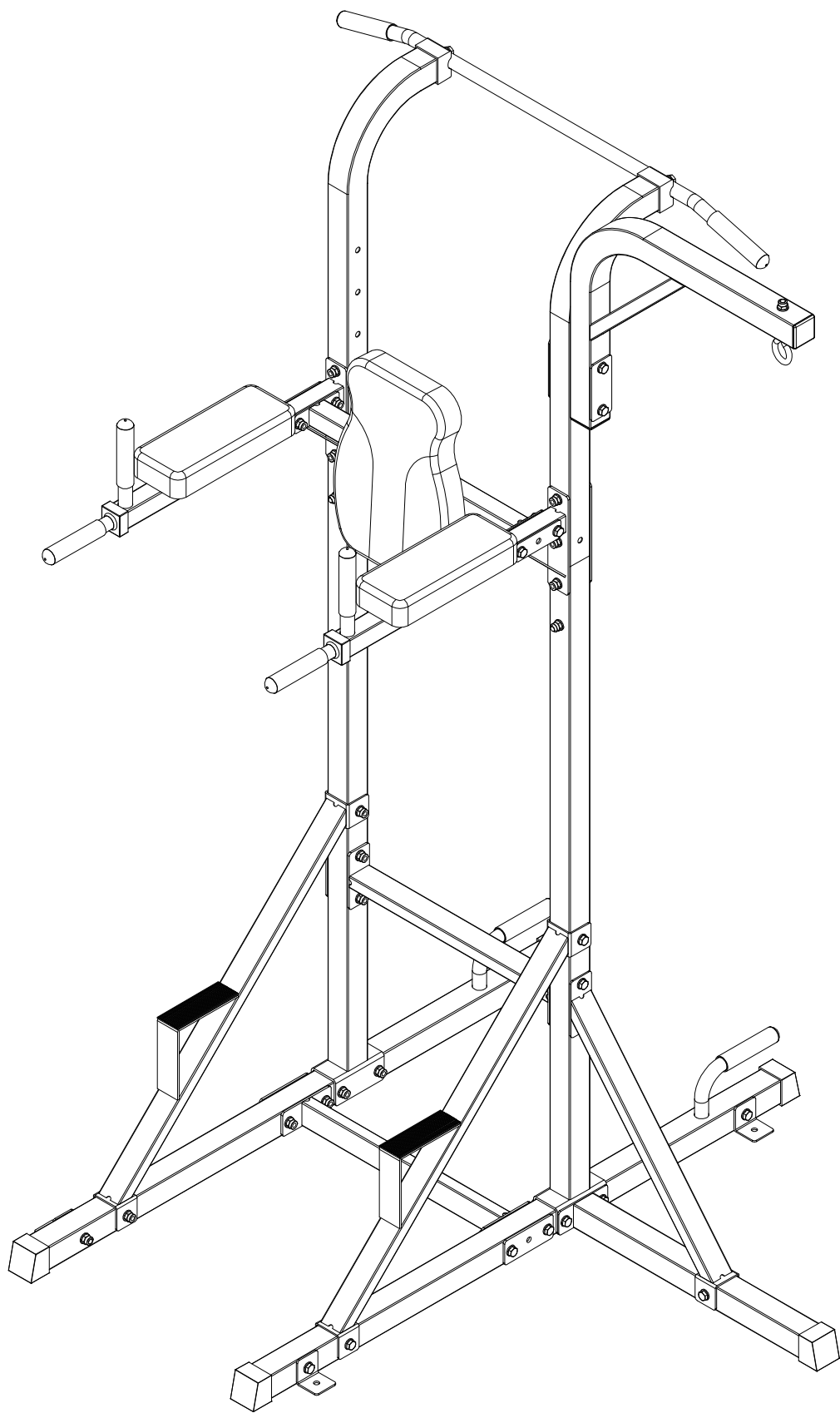

Part list:

No.	Description	Q't y
1	Diagonal support tube	1
2	Boxing bag rack	1
3	Bottom tube	1
4	Connecting plate	2
5	Boxing bag hook	1
6	Outer cap	1
7	Square inner cap	2
8	M10X120 hex bolt	2
9	M10X80 hex bolt	2
10	M10X75 hex bolt	3
11	M10 washer	15
12	M10 nut	8

Part drawing:

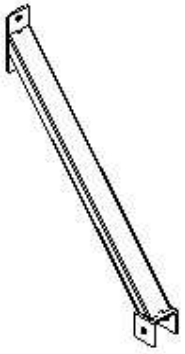

Diagonal support tube

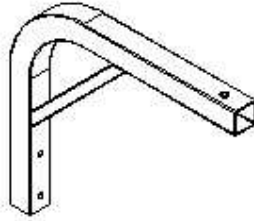

Boxing bag rack

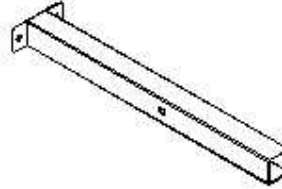

Bottom tube

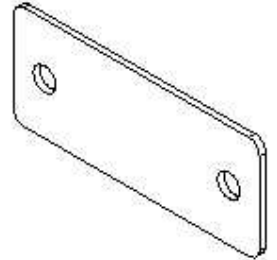

Connecting plate

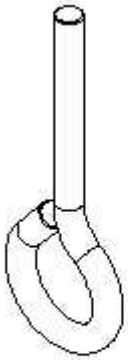

Boxing bag hook

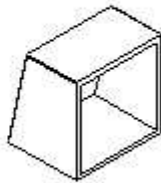

Boxing bag hook

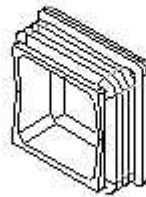

Inner cap

Hardware components:

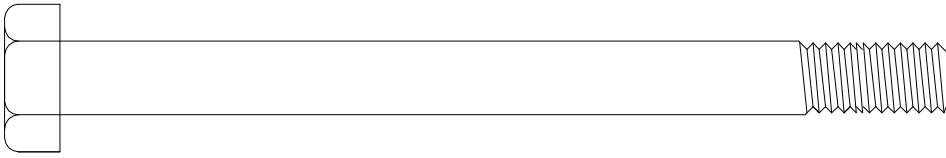

NO. 8 Hex Bolt M10x120mm

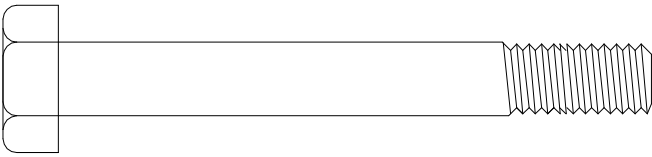

NO. 9 Hex Bolt M10x80mm

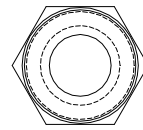

NO.12 Nylon Nut M10

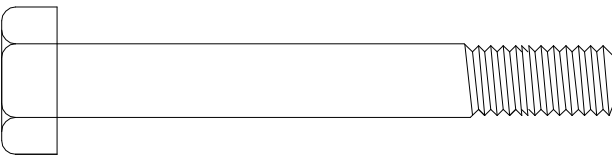

NO. 10 Hex Bolt M10x75mm

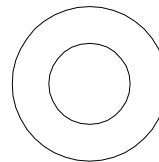

NO. 11 Washer M10

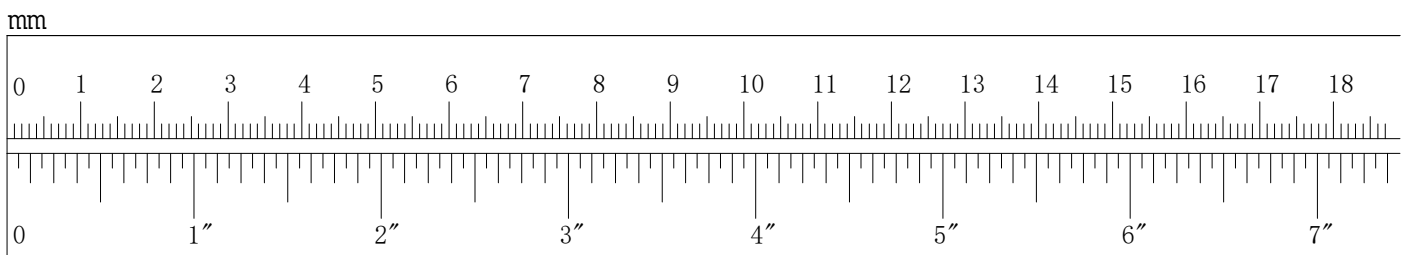

Exploding drawing:

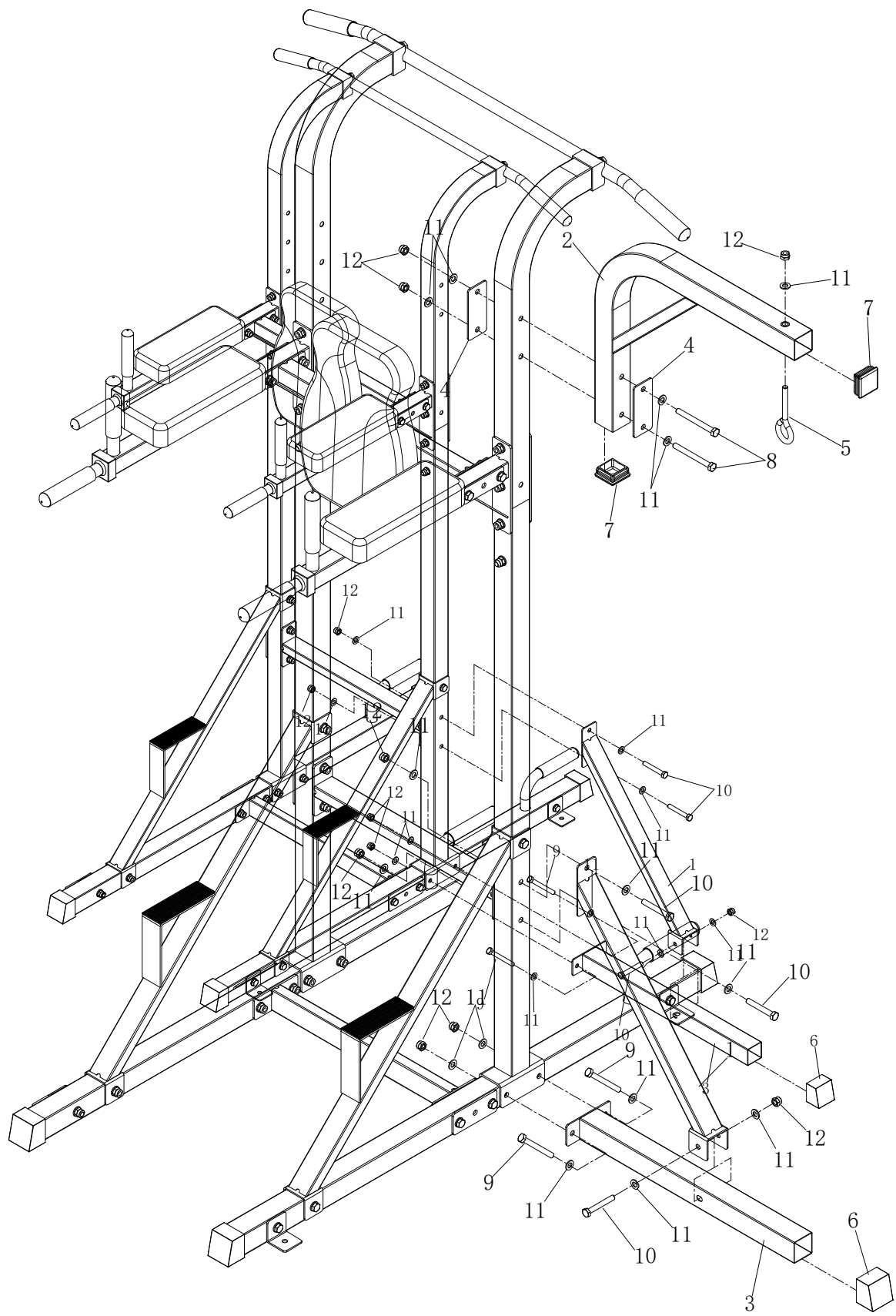

Assembly instructions:

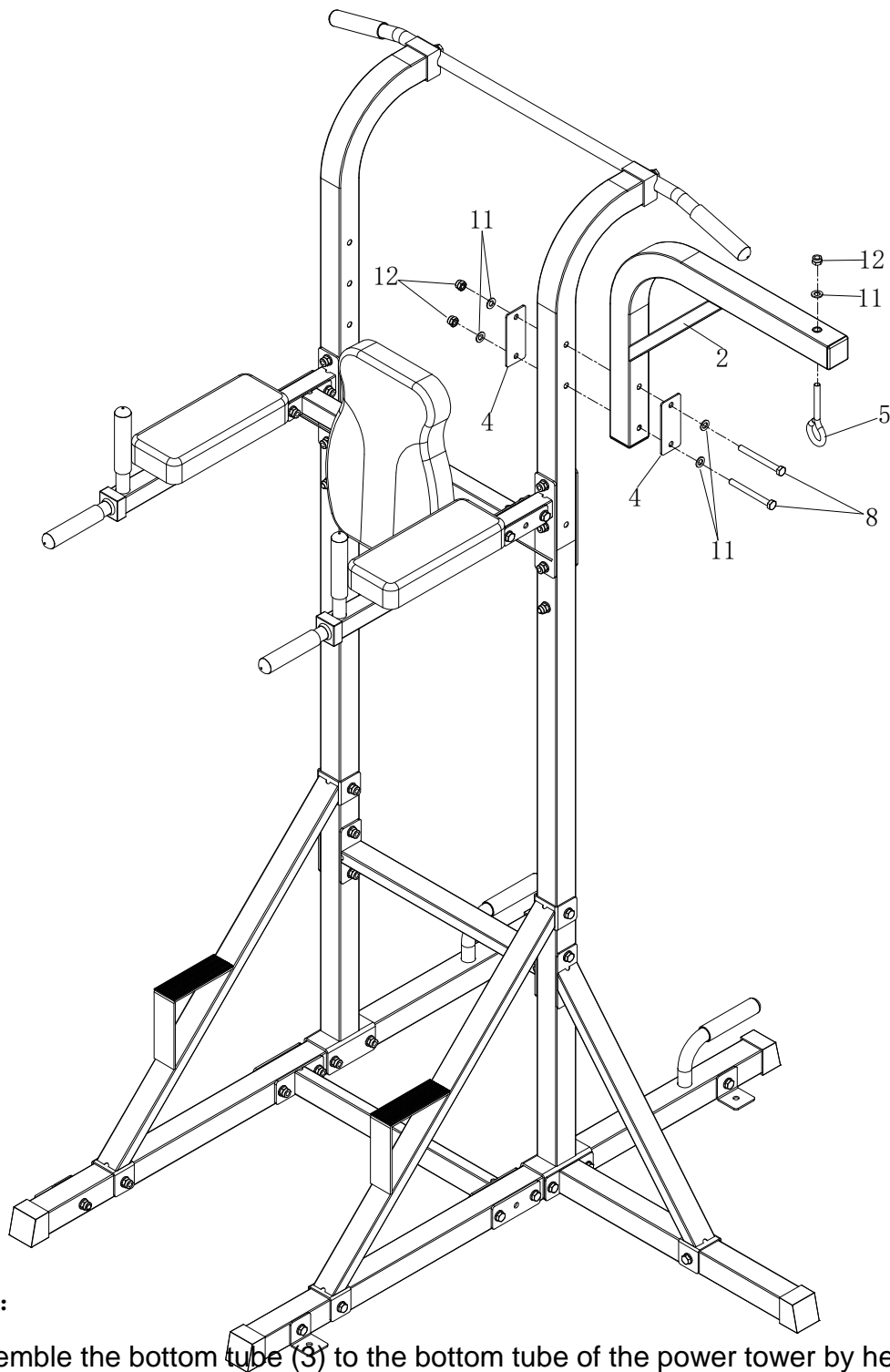

Step 1:

- a) Assemble the bottom tube (3) to the bottom tube of the power tower by hex bolt (9), washer (11) and nut (12) and fix tightly.
- b) Put the U shaped bracket of the diagonal support tube (1), and fixed by hex bolt (10), washer (11) and nut (12) tightly. Then screw the plate of the diagonal support tube (1) to the upright post by hex bolt (10), washer (10) and nut (12) and fix tightly.

Step 2:

- a) Insert the boxing bag hook (5) to the boxing bag rack (2) and fixed by washer (11) and nut (12).
- b) Connect the boxing bag rack (2) to the connecting plate (4) by hex bolt (8), washer (11) and nut (12) and screwed to the right upright post tightly.



GARLANDO SPA
Via Regione Piemonte, 32 - Zona Industriale D1
15068 - Pozzolo Formigaro (AL) - Italy
www.toorx.it - info@toorx.it